

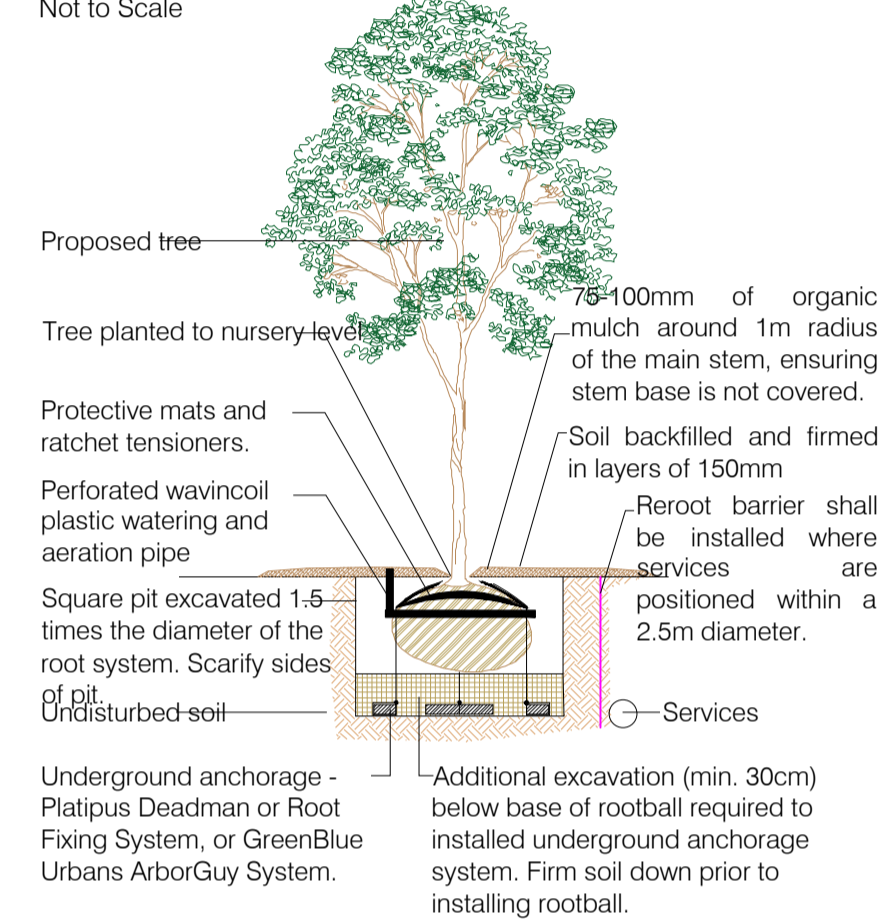

LEGEND;

- 2.5M RADIUS FROM TREE CENTER POINT. WHERE SERVICES OR HARD LANDSCAPE IS LOCATED WITHIN THE 2.5M ROOT BARRIER MUST BE INSTALLED. ON SITE RANDOMISED INSPECTIONS WILL BE CARRIED OUT BY COUNCIL.
- 7M RADIUS FROM CENTER LIGHT FIXTURE NO LARGE TREES TO BE PLANTED WITHIN RADIUS
- SURFACE WATER DRAINAGE
- FOUL WATER DRAINAGE
- EXISTING FOUL WATER DRAINAGE
- WATERMAIN #200mm
- WATERMAIN #150mm
- WATERMAIN #100mm
- ATTENUATION AREA
- FIRE HYDRANT

Detail 1: Tree Planting Underground Guying
Not to Scale



Detail 2: Standard Rootball Tree Planting Specification
Not to Scale

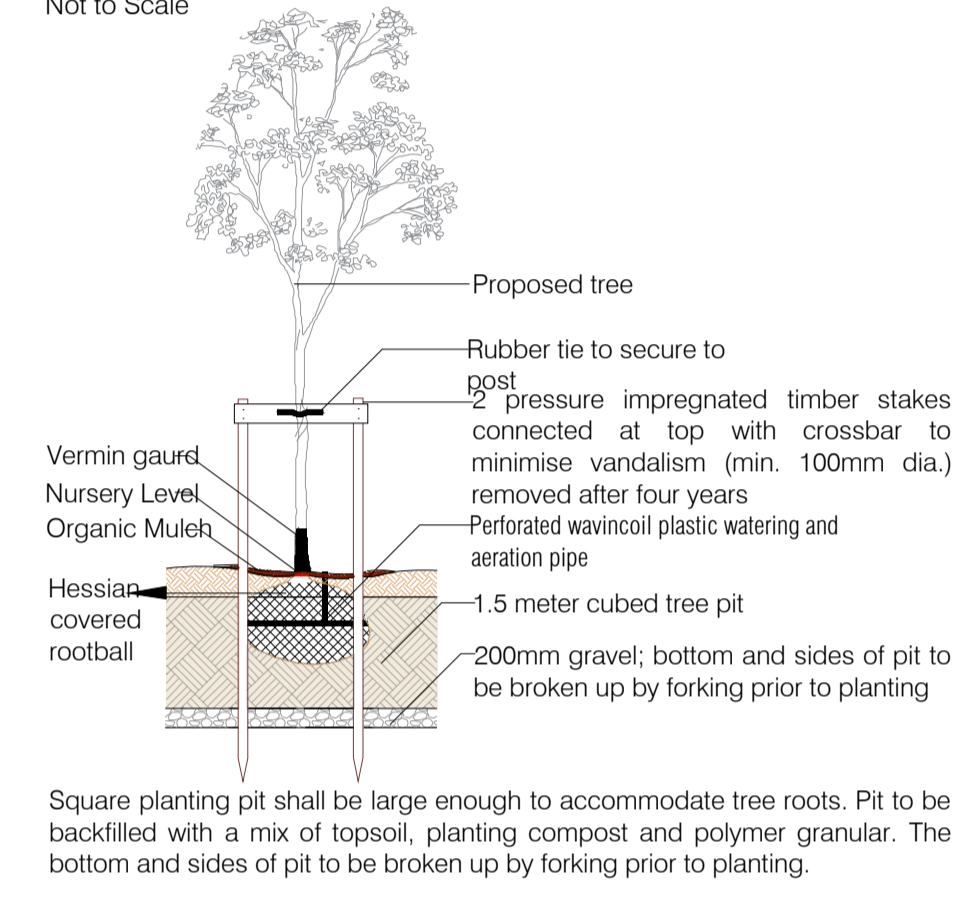

Single stake 12-14cm with Root barrier
Not to Scale

